

1st Floor

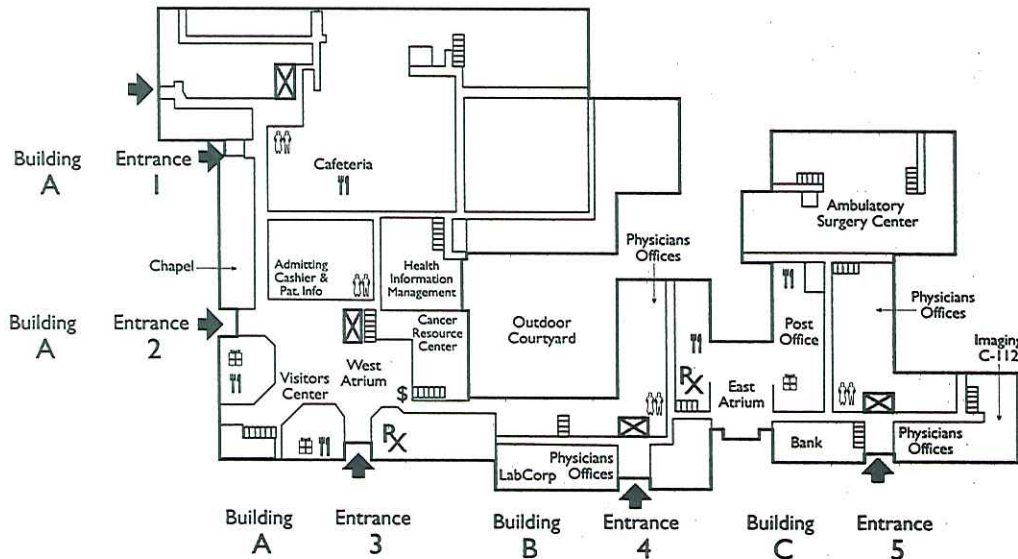

LEGEND

- Public Elevator
- Public Stair
- Public Restrooms
- Pharmacy
- Restaurant
- Shops
- ATM

PHYSICIAN OFFICES

Building A	Floors 1-3
Building B	Floors 1-4
Building C	Floors 1-8
Building D	Floors 4 & 5

DEPARTMENTS

Building / Floor	Department	Elevator
A2	Administration	A - North
A1	Admitting	
C1	Ambulatory Surgery Center	
C1	Bank (Compass)	
A1	Cafeteria	
A1	Cancer Resource Center	
D3	Cardiothoracic Unit	D
D3	Cardiac Catheterization (Cath Lab)	D
C2	Cardiac Rehab	C
A2	Cardiopulmonary Services	A - North
A1	Cashier	
E3	CDU	E
A1, E3	Chapel	
A1	Chaplain	
E2	Conference Center/City Hall	E
A2	Day Surgery	A - North
E5	Dialysis	E
E2	Education	E
A3	EKG	A - North
E3	EMERGENCY	E
A2	GI Lab	A - North
D2	Human Resources	D
D3	Cardiovascular ICU (CVICU)	D
E4	Medical ICU	E
E4	Neurovascular ICU	E
E4	Surgery ICU	E
C1	Imaging (C-112)	C
A1	INFORMATION	
D2	Infusion	D2
D7	Labor and Delivery	D
A2	Laboratory (Hospital)	A - South
A1	Laboratory (LabCorp)	
A1	Medical Records/HIM	
D2	Outpatient Imaging (D-200)	D
C2	Physical Therapy	C
C1	Post Office	
D1	Radiation Oncology	D
A2	Radiology	A - North
A2	Respiratory Therapy	A - South
B2	Security/Parking	B
A4	Sleep Disorders Center	A - North
E5 E6	Telemetry	E
C7	Transplant Center	C
A2	Vascular Center	A - South
A1 E3	Vending	
A1	Visitor Center	
A1	Volunteers	
C2	Wound Care Center	C
A7-A9	Women's Services	A - North
C2	Women's Wellness Center	C

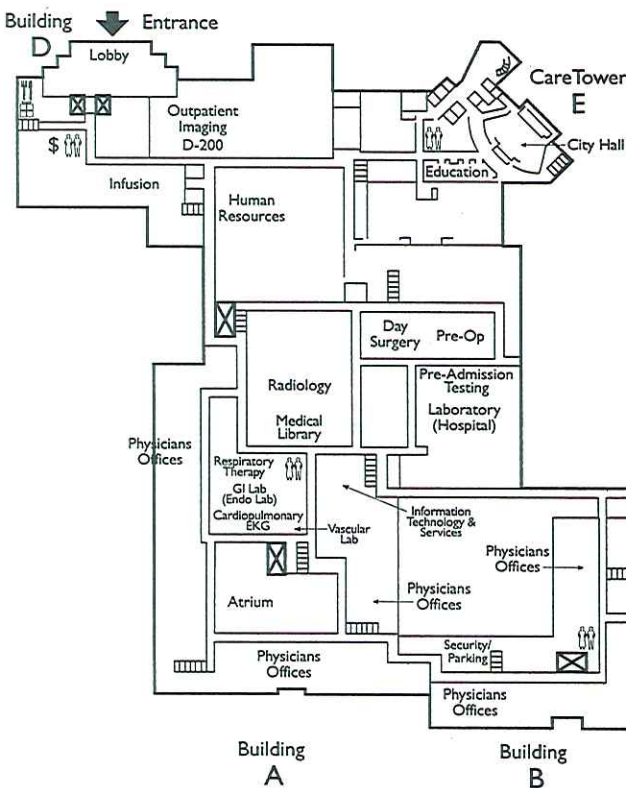

2nd Floor

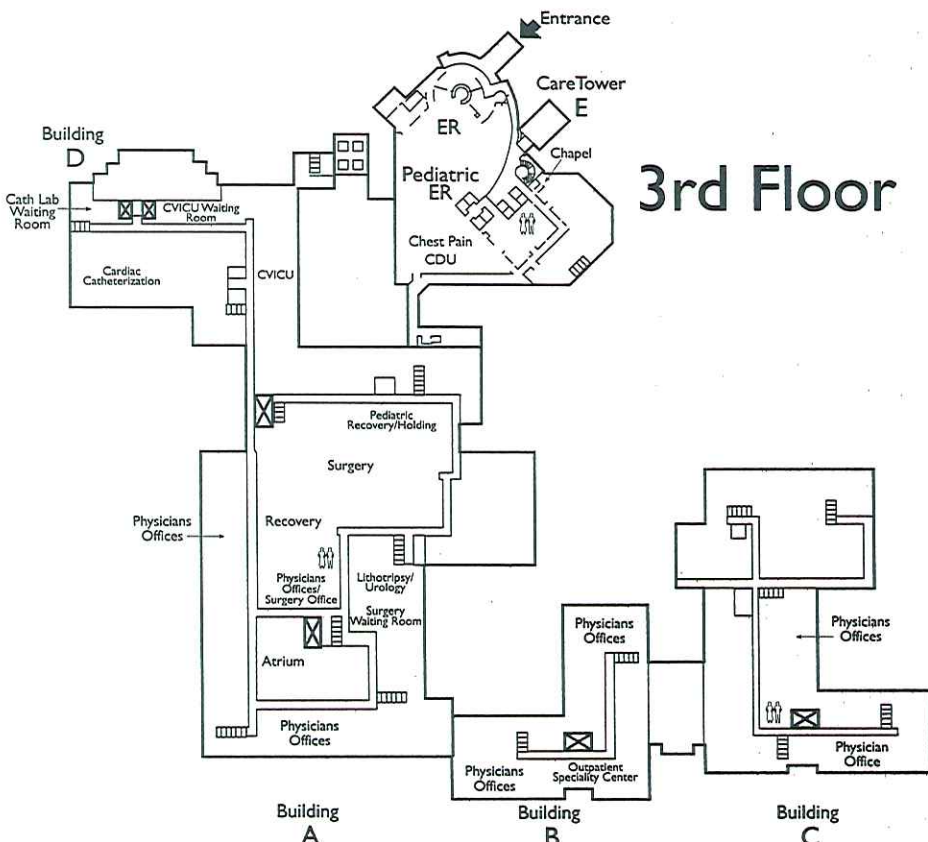

3rd Floor



A5	Congenital Heart Surgery Unit	A-North
E3	EMERGENCY	E
A4	Neonatal ICU	A-North
A5	Pediatric ICU	A-North
D7	Nursery	D
B3	Outpatient Specialty Center (B-300)	B
A5	Pediatric Ambulatory Surgery	A-South
A6	Pediatrics	A-North
D6	Pediatrics	D